



User Manual

LOW-VOLTAGE CENTRAL VACUUM HOSE



Model Number:

ACCHO-30/35/40/50LV-BK

2. LOW-VOLTAGE HOSE



NOT TO BE USED WITH AN ELECTRICAL CARPET BEATER (POWER HEAD)



2.1 Compatibility

The hose is compatible with most wall inlets. Inlets must have a 1.5" inner diameter (**A**) in order for the hose to fit, and must have 2 low-voltage pins/metal prongs (**B**) in order to turn the hose ON/OFF from the switch located on the hose handle.

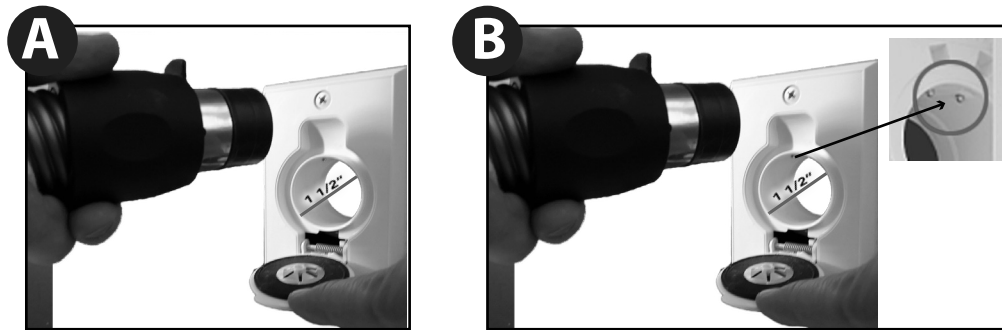

2.2 Connecting the hose to the wall inlet

The hose end cuff must be connected as shown in the picture below. The black part on the end cuff must be well aligned with the 2 pins inside the inlet (**C**). The plastic square must be facing up (**D**).

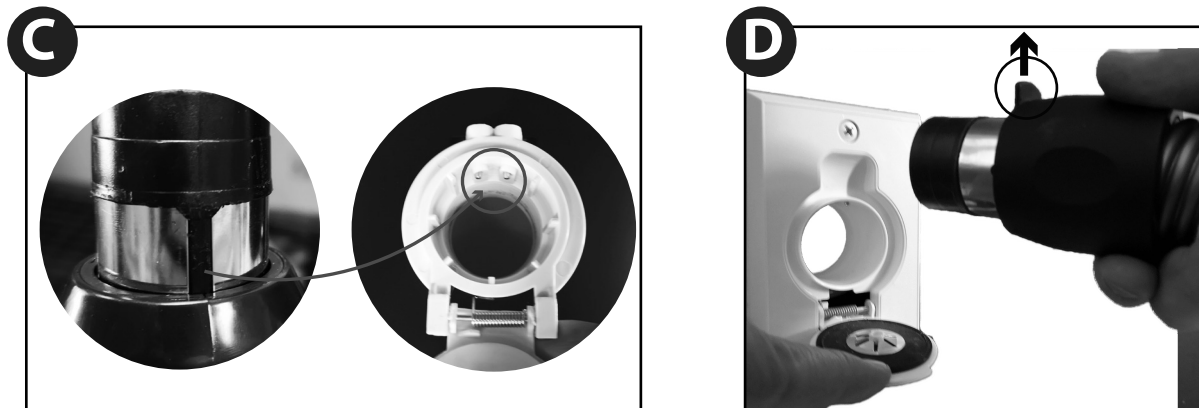

2.3 Starting and stopping your central vacuum

If your inlets have 2 low-voltage pins inside as demonstrated in step 2.1, you will be able to start and stop your central vacuum directly from the switch on the hose handle.

